



BOUNDARY TREATMENT E: SECURE WELDMESH FENCING

ABOVE + ABOVE LEFT: 2.00m ht weldmesh fencing system to provide secure enclosure to private gardens and to the creche amenity outdoor playspace. Fence to be manufactured and



constructed to BS 1722-14 category 1. Striped mesh using 5mm horizontal wire at 195mm centres, with a V-crimp. Fence to be finished in polyester powder coating to EN 1722 Pt 16. 60x60x2mm galvanised posts at 3.03m centres with panels fixed with Irlen steel clips and anti-vandal bolts.

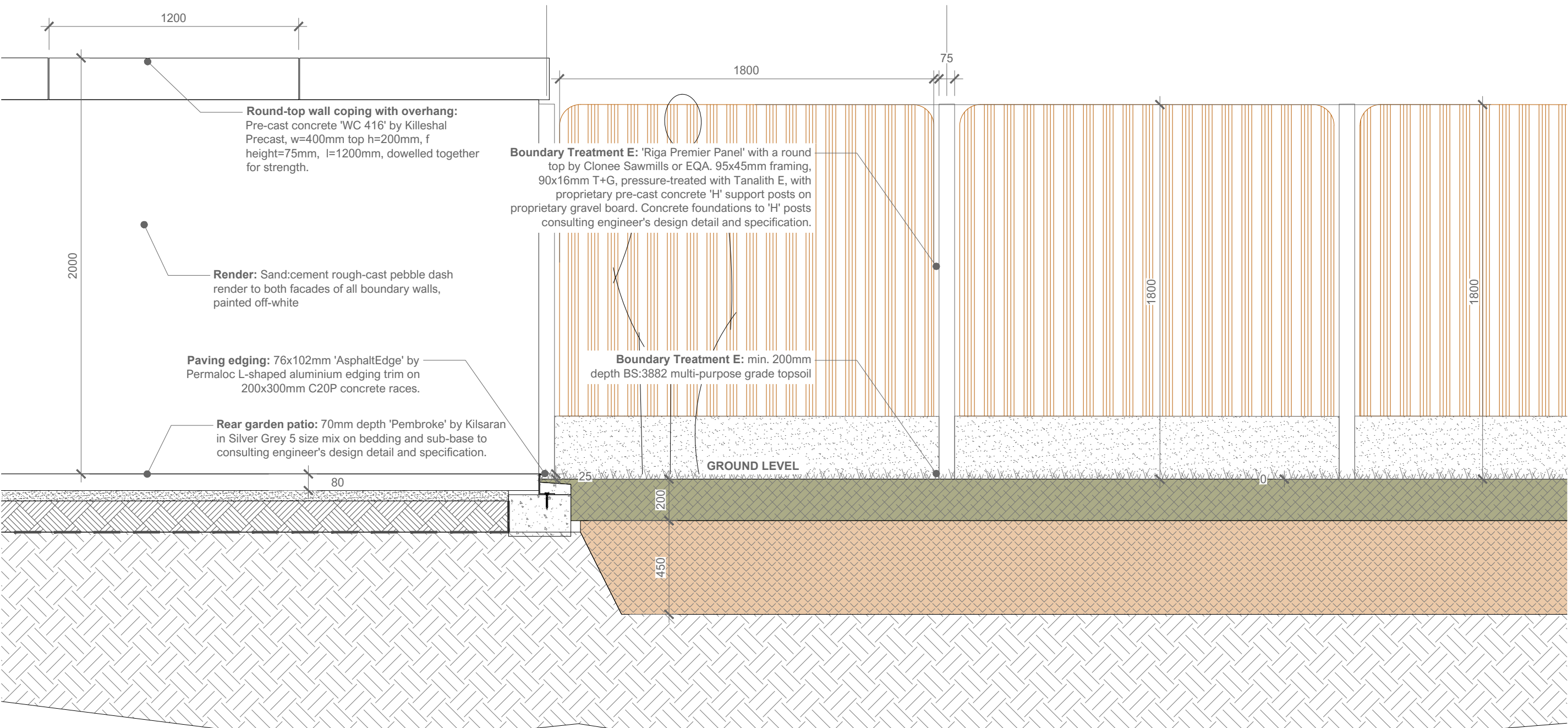
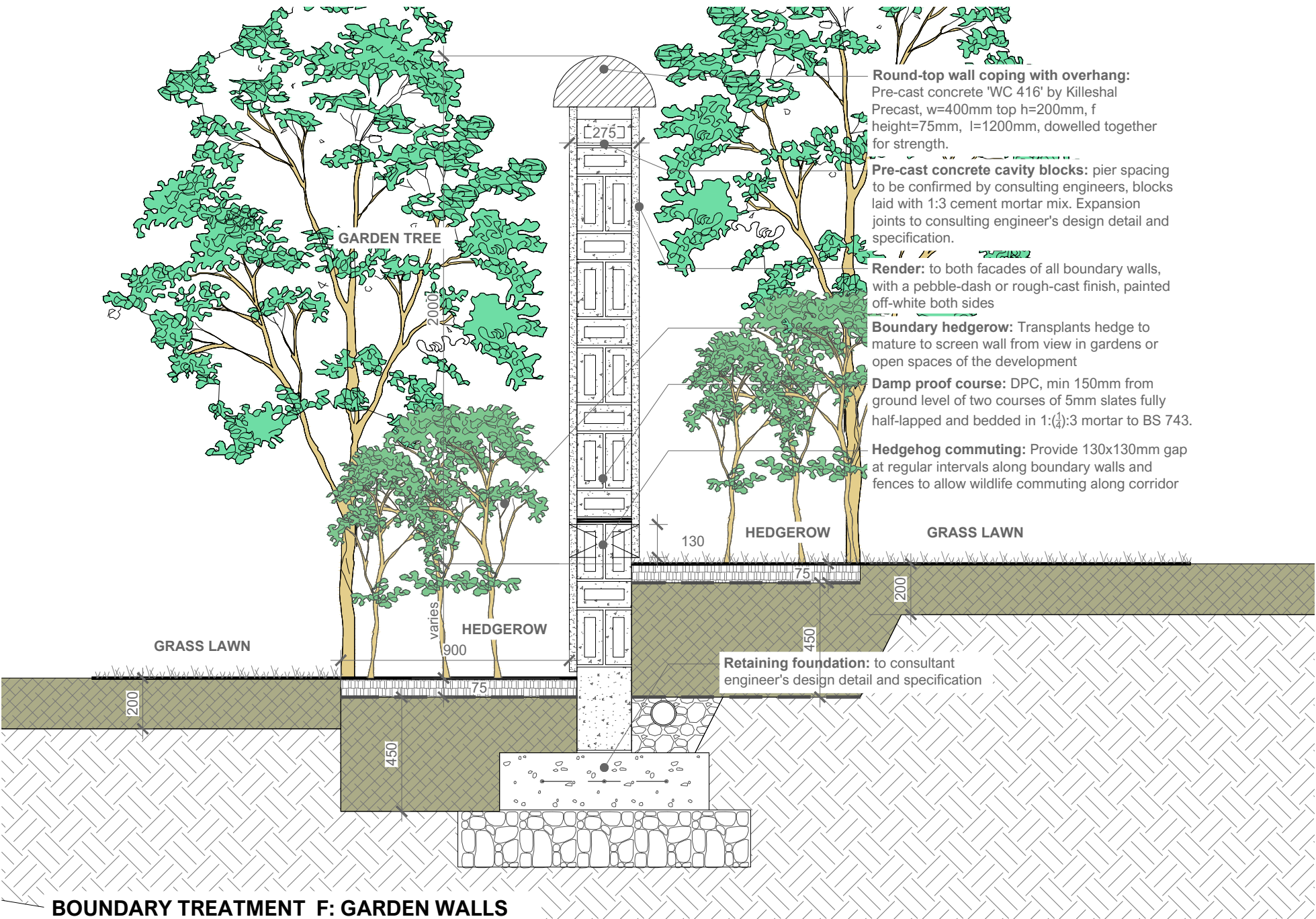

BOUNDARY TREATMENT G: GARDEN FENCES
SCALE 1:20

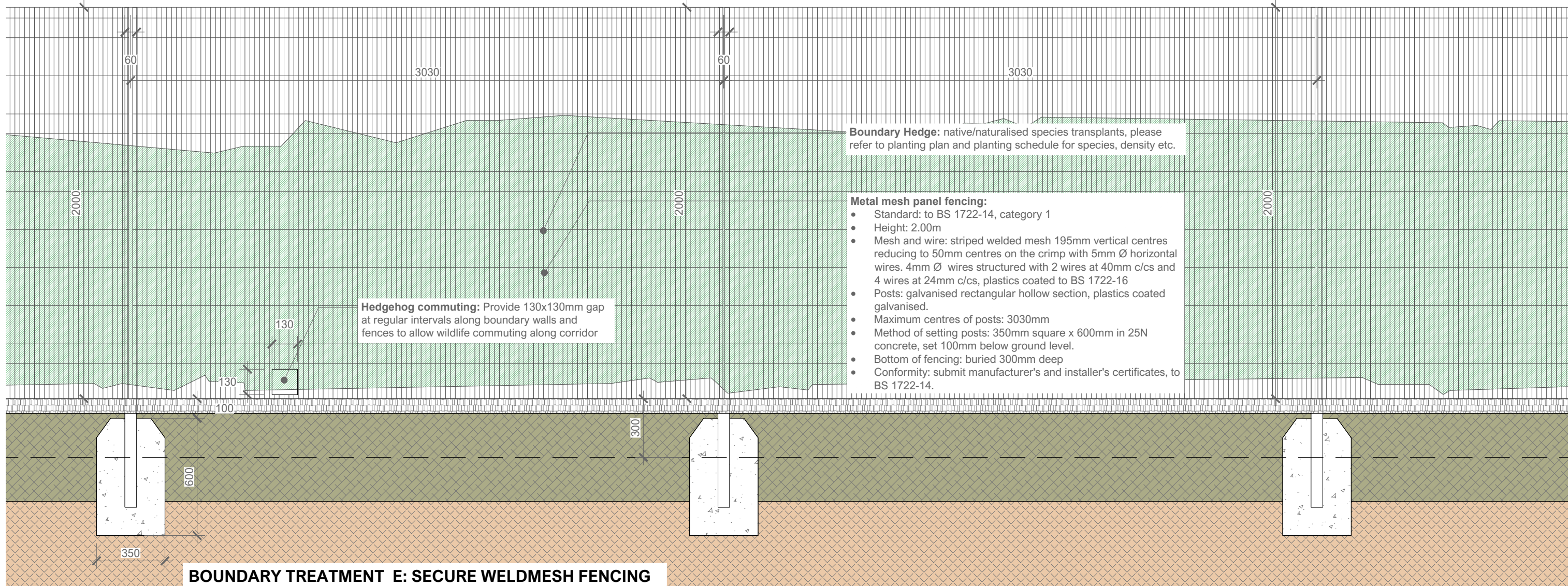

BOUNDARY TREATMENT E: SECURE WELDMESH FENCING
SCALE 1:20

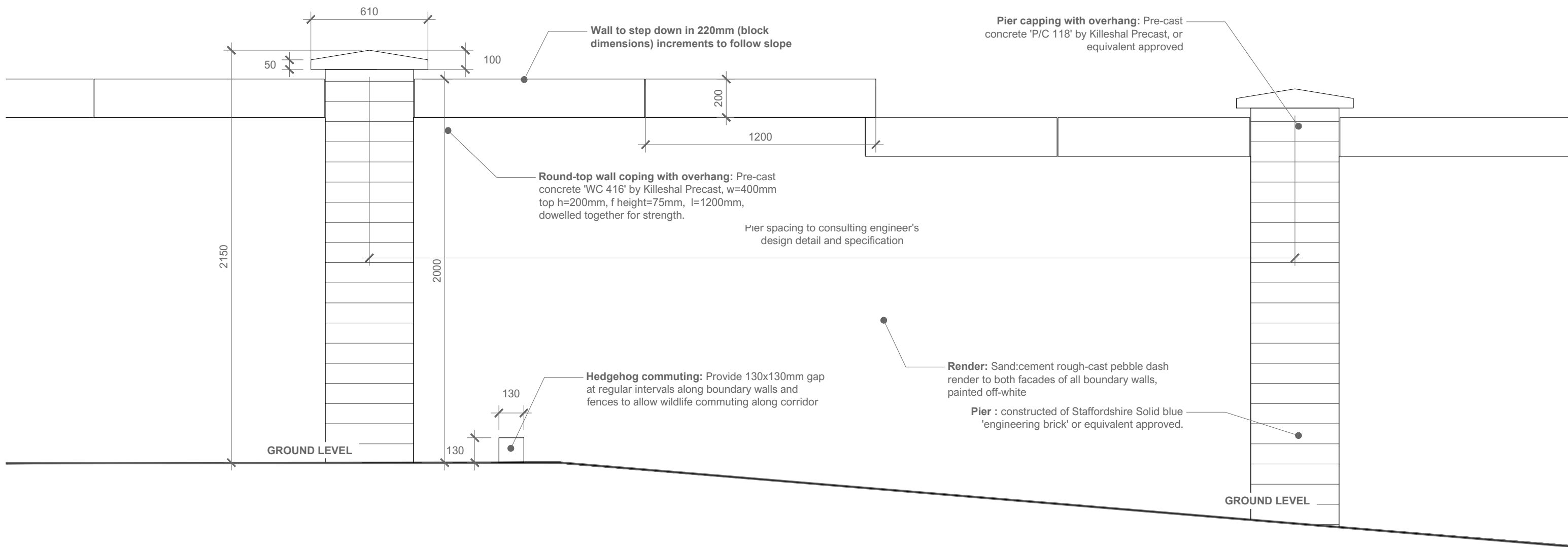

BOUNDARY TREATMENT F: GARDEN WALLS
SCALE 1:20

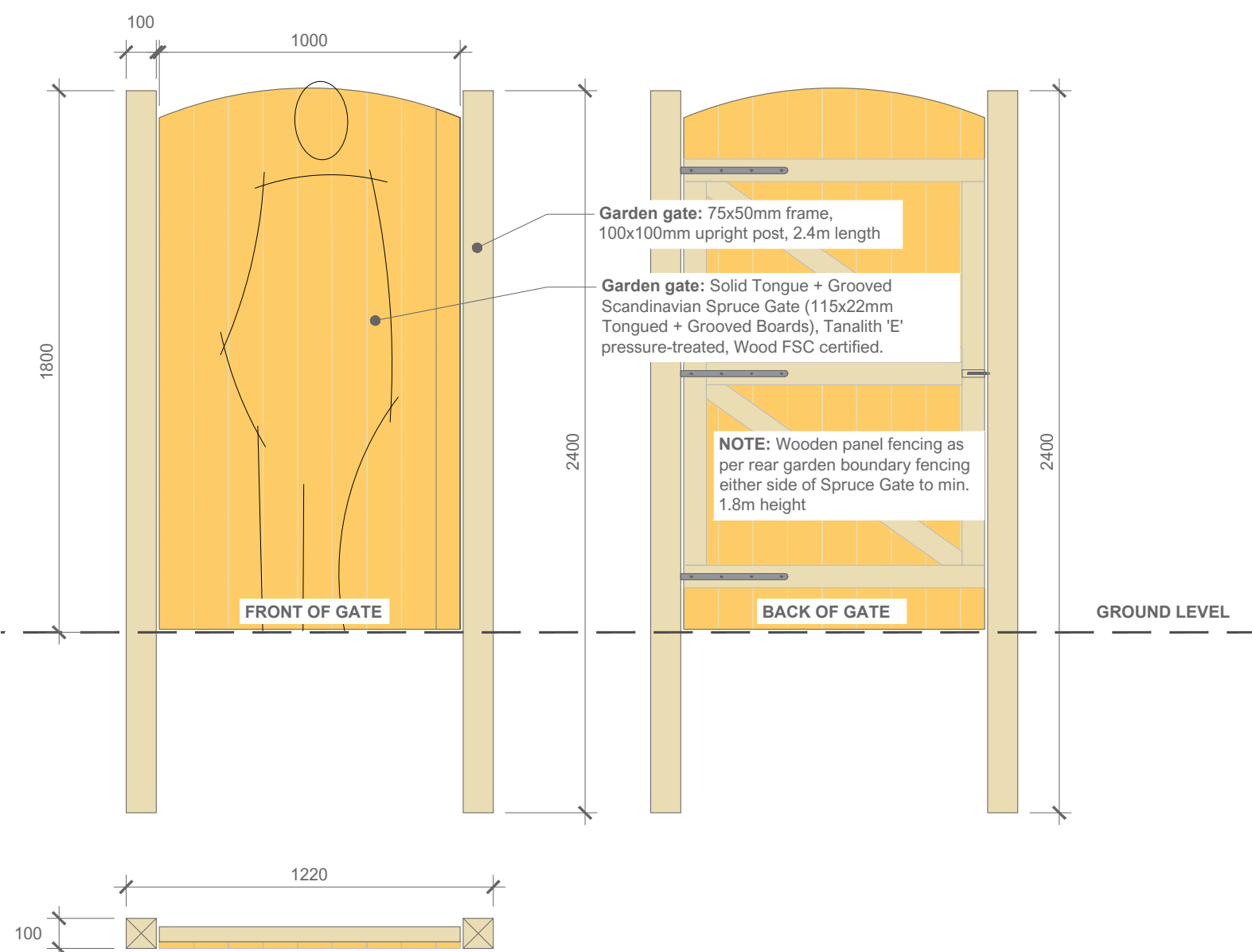

BOUNDARY TREATMENT G: GARDEN FENCES (GATES)
SCALE 1:20

BOUNDARY TREATMENTS OUTLINE SPECIFICATION KEY	
All foundations, piers, reinforcing mesh, concrete sub-bases and geotextiles to engineers'/architects' design detail and specification. All retaining walls to engineer's design detail and specification.	
LOCATION OF PROTECTIVE FENCING TO EXISTING TREES Indicative line of Tree Protection Fencing for trees and vegetation to be retained as per consulting arborist's report and drawings, to meet BS 5837 'Trees in Relation to Design, Demolition & Construction'. Area indicating Work Exclusion Zone around trees to be retained, protected with protective fencing as per arborist's 'Tree Protection Measures'. Tree protection fencing must be erected before demolition or construction work commences on site, and should remain in place until their removal or relocation is authorised by a qualified arborist.	
	BOUNDARY TREATMENT A - WOODEN BOLLARDS IN VERGE 0.60m ht. from FGL (finished ground level) weather-steel FSC (hardwood or pressure-treated softwood) 200x200mm size bollards at 1.80m centres, secured with counter-sunk galvanised steel dowel into concrete foundations to engineer's design detail and specifications, free-draining under wooden bollard with pea gravel
	BOUNDARY TREATMENT B - WALL TO CARLEY'S BRIDGE ROAD 0.90m ht. coursed random rubble locally-sourced granite wall with rounded granite ashlar cappings and quoins, railings and integrated development signage along the public road (Carley's Bridge Road) frontage. Rear of wall on site-side to be planted with mixed native species transplant hedgerow
	BOUNDARY TREATMENT C - 'ALPINE' ROAD SAFETY BARRIER 0.69m ht. semi-rigid composite barrier of steel U-beams and rails with horizontal 18cm Ø round log wooden rail cladding (e.g. 'Birsta TM18' or equivalent approved) to prevent vehicles from leaving the road and hitting roadside hazards such as slopes or accidentally entering the riverside park, along the boulevard road. Fence must be motorcycle friendly, manufactured in accordance with ISO 9001, compliant with EN 1317 and crash-rated to N1, N2 and H2 containment levels, CE certified. 39.5cm overall thickness to fence, C100 steel posts in 1.50m lengths, covered with wood. New hornbeam hedgerow to be planted to southern side of road safety barrier along the length of the boundary to the riverside amenity open space
	BOUNDARY TREATMENT D - RIPARIAN BUFFER ZONE FENCING 1.20m ht. sweet chestnut post-and-pale fencing with steel stabilising wire mesh, along the Urrin River and tributaries, to ensure the streamside zone is protected, and left intact in an undisturbed natural state. Works along the min. 10.00m width 'Streamside Riparian Zone' buffer to be undertaken by hand-dig only to comply with Inland Fisheries Ireland guidelines 'Planning for Watercourses in the Urban Environment', 2020. Provide matching chestnut gates at intervals to ensure access for anglers is maintained.
	BOUNDARY TREATMENT E - SECURE WELDMESH FENCING 2.00m ht. striped mesh fence e.g. 'Kilbarr' by Irish Fencing Services with V-crimps for rigidity with proprietary double leaf swing self-closing gates at entrances, all to BS1722-14 category 1. Panels to be fixed with steel clips and anti-vandal bolts to 60x60 galvanised posts. All to be finished with polyester powder coating to EN 1722 Pt 16, colour 'Olive Grey' RAL 7002. Provide opes suitable for hedgehog commuting. Hedge planting to be provided to garden-side of all mesh fencing in rear domestic dwelling gardens; locking system + intercom to be provided to double gates provided to amenity open space of creche to ensure safe and secure staff entrance/occasional maintenance access if required.
	BOUNDARY TREATMENT F - DWELLING GARDEN WALLS 2.0m ht. 'rough-cast' rendered both sides concrete blockwork boundary wall with pre-cast round-top concrete capping 200mm ht. Walls to be painted to selected RAL colour to harmonise with landscape. Where walls form rear garden boundaries, they are to be planted with a hedgerow on the garden side
	BOUNDARY TREATMENT G - GARDEN FENCES 1.80m ht. wooden panel fence with concrete posts to rear gardens of dwellings. Wooden gates to side access footpaths. Provide opes suitable for hedgehog commuting
	BOUNDARY TREATMENT H - LANDSCAPE FENCES 1.20m ht. sweet chestnut cleft post-and-pale fencing with steel stabilising wire mesh with an expected lifespan of 20 years or more, made from sustainable natural resources from coppices plantation. Fencing to be suitable to accommodate changes in topography, 4 no. horizontal galvanised 2.00mm wire strands per row of fencing with support posts, struts and anchor posts of treated softwood. Pales to be cleft, peeled and pointed one end, with approx 81 pales in a 9.10m length roll. Intermediate rounded 75mm Ø 1.65m length posts at 2.50m intervals, with 100mm Ø corner and end-posts at 45.00m intervals, corners and changes of direction. Provide 200x200mm 2.40m length pressure-treated Douglas Fir heavy duty gate posts and closed goose-neck style 1.50/1.20m softwood gate with stainless steel ironmongery and fixings to communal amenity open spaces or playspaces where indicated.
	BOUNDARY TREATMENT J - INFILL PLANTING Gaps identified by consulting arborist in existing hedgerows to be in-filled with new mixed native species transplant hedgerow planting. Hedgerows to be protected by cleft sweet chestnut pale and post fencing
	BOUNDARY TREATMENT K - ESTATE RAILING 1.20m ht. 5-rail estate railing ('Kilbarney' by Irish Fencing Systems or EQA) modular fence to enclose front gardens to dwellings. 50x60mm solid flat posts at 1.00m centres. Hot-dip galvanised mild steel, powder-coated to 'Olive Grey' RAL 7002. Hedge to be planted on garden side of estate rail fencing. 1 no. 20mm Ø top horizontal rail, 4 no. 28x6mm solid horizontal flat rails, welded to posts. Proprietary estate type railing gates to gardens. Fence to be backed by sweet chestnut pale and post fencing. Fence to be mounted behind 300mm width granite kerb at junction with concrete paths.

General Notes:

- This drawing is the copyright of Landscape Design Services landscape architects.
- This drawing must be read in conjunction with all relevant design team and surveyor's drawings, details and specifications. Unless otherwise stated all dimensions are in millimetres.
- Where dimensions are not given, drawings must not be scaled and the matter must be referred to the Landscape Architect. Similarly if the drawings contain conflicting details or dimensions.
- If the drawing includes conflicting details/dimensions the matter must be referred to the Landscape Architect.
- All dimensions must be checked on site prior to construction or fabrication.
- The Landscape Architect must be informed, by the Contractor, of any discrepancies before work proceeds.
- This drawing has not been prepared for BCAR, BCMS or DAC purposes, and has not been prepared to demonstrate compliance with the Building Regulations.



**landscape
design
services**

LANDSCAPE ARCHITECTS & CONSULTANTS

Boden Park, Ballyboden, Dublin 16, Ireland t: 01 9104387 e: info@landscape-design.ie

PROJECT	PROPOSED RESIDENTIAL DEVELOPMENT AT CARLEY'S BRIDGE, ENNISCORTHY, CO. WEXFORD
CLIENT	TORCA DEVELOPMENTS LTD
PROJECT ARCHITECT	BRIAN DUNLOP ARCHITECTS
JOB NO.	20_174
STAGE	PLANNING
DRAWING	PROPOSED BOUNDARY DETAILS 2.3
DRAWING NO.	20_174-PD-018
DRAWN BY	J COUGHLAN MLI
CHECKED	COLM KENNY MLI
FIRST ISSUED	03.06.2020
REVISION	C
STATUS:	PLANNING
SCALE	1:20, NTS
THIS ISSUE	11.10.2021

NOTES:
All dimensions are in millimetres unless otherwise stated and shall be checked and confirmed by the contractor on site. Any discrepancies shall be immediately reported to the landscape architects. Work to figured dimensions only - Do not scale from drawing. Do Not Scale. Use Figured Dimensions Only. Not for Construction Purposes unless Specifically Marked.

© THIS DRAWING IS COPYRIGHT OF LANDSCAPE DESIGN SERVICES