



01 FRONT ELEVATION
181 1:200 @ A1



02 REAR ELEVATION
181 1:200 @ A1



03 SIDE ELEVATION
181 1:200 @ A1



04 SIDE ELEVATION
181 1:200 @ A1



05 SECTION A-A
181 1:200 @ A1

NOTES RELEVANT TO PARTICULAR JOB STAGE:

SKETCH AND DESIGN STAGE

ALL DRAWINGS ARE FOR DISCUSSION PURPOSES ONLY. DRAWINGS ARE NOT TO BE USED FOR ANY OTHER PURPOSE.

PLANNING STAGE
ALL DRAWINGS ARE FOR PLANNING APPLICATION PURPOSES ONLY.
DRAWINGS ARE NOT TO BE USED FOR ANY OTHER PURPOSE. ANY
CHANGES MADE TO THESE DRAWINGS ARE SUBJECT TO IMMEDIATE
APPROVAL BY BRIAN DUNLOP ARCHITECTS. ANY CHANGES TO THESE
DRAWINGS MAY HAVE PLANNING IMPLICATIONS. FIGURED DIMENSIONS
ONLY TO BE USED FROM THIS DRAWING.

CONSTRUCTION STAGE
ALL DRAWINGS ARE FOR CONSTRUCTION PURPOSES ONLY. DRAWINGS
ARE NOT TO BE USED FOR ANY OTHER PURPOSE. DRAWINGS TO BE
CHECKED ON SITE BY THE CONTRACTOR PRIOR TO COMMENCEMENT OF
ANY WORK. BRIAN DUNLOP ARCHITECTS TO BE INFORMED OF ANY
DISCREPANCIES IMMEDIATELY. FIGURED DIMENSIONS ONLY TO BE USED
FROM THIS DRAWING.

**BUILDING No. 10 -
15 No. APARTMENTS / DUPLEXES**

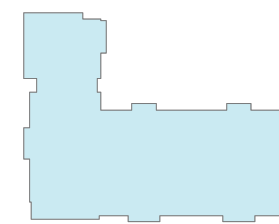

BUILDING No. 10

| UNIT LEVELS | | | |
|----------------------|--------------------|-------------|-------------|
| | Ground Floor Level | Eaves Level | Ridge Level |
| Units 171/172 | 15.200 | 24.098 | 28.452 |
| Units 173/174 | 15.400 | 24.298 | 28.652 |
| Units 175/176 | 18.650 | 24.098 | 28.452 |
| Units 177/178 | 18.850 | 24.298 | 28.652 |
| Unit 179 | 15.900 | 28.575 | 32.099 |
| Unit 180 | 16.400 | 28.575 | 32.099 |
| Units 181/182 | 19.750 | 28.575 | 32.099 |
| Units 183-185 | 22.700 | 28.575 | 32.099 |

BUILDING No. 10

UNIT ORIENTATION

| | |
|---------------|---|
| Units 171-185 |  |
|---------------|---|

BUILDING No. 10

BUILDING FINISHES NOTES:

PITCHED ROOFS TO BE FINISHED IN BLUE / BLACK SLATE OR EQUAL APPROVED WITH COLOURED PVC FASCIA AND SOFFITS TO MATCH.

ALL RAINWATER GOODS TO BE RAL COLOURED PVC TO LATER SELECTED COLOUR. HALF ROUND AND CIRCULAR PROFILE THROUGHOUT.

ALL RAINWATER GOODS TO BE RAL COLOURED PVC TO
TO LATER SELECTED COLOUR. HALF ROUND AND
CIRCULAR PROFILE THROUGHOUT.

EXTERNAL WALLS TO BE A SMOOTH PLASTER FINISH
& SELECTED BRICK WHERE SHOWN.

ALL WINDOWS TO BE U-PVC WITH CONCRETE CILLS.

FRONT ENTRANCE DOORS TO BE OF HARDWOOD CONSTRUCTION TO LATER SELECTED DETAIL AND COLOUR.

CANOPY OVER FRONT ENTRANCE DOOR TO BE
SELECTED ZINC CLADDING PROFILED AS INDICATED

GLASS BALUSTRADES TO ALL BALCONIES WHERE
INDICATED.

NOTES:

DRAWING TO BE READ IN CONJUNCTION WITH ALL OTHER DRAWINGS AND DOCUMENTS BY BRIAN DUNLOP ARCHITECTS AS PER THE ENCLOSED DRAWING REGISTER.

| | | |
|------|----------------------------|--------|
| | | |
| | | |
| | | |
| | | |
| | | |
| | | |
| A | ISSUED FOR SHD APPLICATION | AUG 20 |
| REV. | NOTE | DATE |

CLIENT:
TORCA DEVELOPMENTS

DEVELOPMENT:
HOUSING DEVELOPMENT

LOCATION:
CARLEYS BRIDGE, ENNISCORTHY, Co. WEXFORD

DRAWING TITLE:
BUILDING TYPE 10 - ELEVATIONS & SECTION

brian dunlop architects

Address: 15 Patrick Street, Kilkenny
Telephone: 056 7813015
E-Mail: info@bdarchitects.ie
Website: www.briandunloparchitects.com



PLANNING DRAWINGS



PRACTICE
ACCREDITED IN
CONSERVATION
G3
PIAI

© BRIAN DUNLOP ARCHITECTS.
THIS DRAWING AND THE DESIGN THEREON IS COPYRIGHT AND MAY NOT BE
REPRODUCED, DISTRIBUTED OR USED FOR ANY PURPOSE WITHOUT THE
WRITTEN CONSENT OF BRIAN DUNLOP ARCHITECTS.